

ALPA\\ INSIDE GROOVES DIGITAL CALIPERS IP67

MEGAline



ITEM: AA086

0,01mm resolution - Swiss technology with data output and protection IP67. (full submersion) also cable connected. Automatic power on, by moving the vernier along its rod. (SIS system) pausing after 20 min when not in use, pause setting kept stored with max movement speed of 2.5 m/sec. Structure mechanics in tempered, rectified stainless steel. Locking screw. Provided with ABS casing.

Tech. Code	Measuring range mm	A mm	B mm	E mm
D014610170	10 + 170	230	3,5	16,5 x 4
D014620180	20 + 180		8,5	

Tech. Code	Model
D99113V	Battery 3V DL2032 - CR2032
D0002USB	Connection cable Proximity-USB
D0002RS232	Proximity -cable RS232

ALPA\\ INSIDE GROOVES DIGITAL CALIPERS



ITEM: AA179

0.01mm resolution - Metal casing, ON/OFF button, vernier with locking screw, pre-setting function.

Tech. Code	Measuring range mm	A mm	B mm	C mm	E mm
D0156150	14 + 150	12	1	30	5
D0156200	18.5 + 200	13		40	
D0156300	17 + 300	15	1.5	50	8
D0156500	35 + 500	33		120	

Tech. Code	Model
D99113V	Battery 3V DL2032 - CR2032

ALPA\\ DIGITAL CALIPERS WITH INTERCHANGEABLE TIPS



ITEM: AA077

0.01mm resolution (ON/OFF) button, zero setting at any position and incremental zero setting (ABS), vernier with locking screw, complete with a set of M2.5 thread probe tips.

Useful for external and internal measure.

Different tips to be ordered separately, see table at page D.51

Tech. Code	Measuring range internal mm	Measuring range External mm	A mm	B mm	D mm	L mm
D0160300	40 + 300	0 + 300	75	12	19	430
D0160500	50 + 500	0 + 500	88	16	23	680

Tech. Code	Model
D99113V	Battery 3V DL2032 - CR2032

ON-LINE
MANUAL

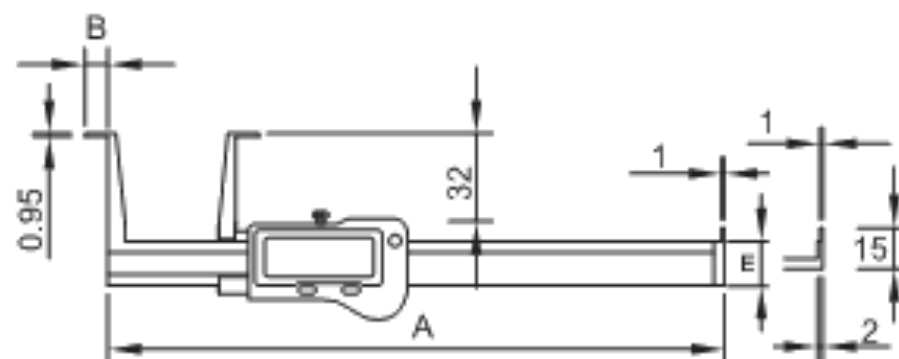

ON-LINE
MANUAL

