

G CENTERING PLATE (INOX)

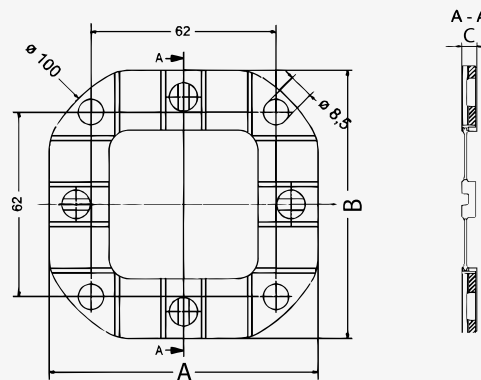

CODE	A	B	C
NBM.ACTR	90	90	5

The location has to be milled to allow for the correct positioning and prevent the chucking spigot "F/A" (automatic) from twisting.
Ensure that the positioning device is attached in a manner that aligns the pallet or jig according to your specifications when placed in the Robot magazine.
The "F/A" chucking spigot can be positioned at intervals of 90°.
Eight supporting feet increase the tilting stability of the pallets and jigs by 30 %